

Signature Miniature Golf



GSA GOLFSports
GMBH

Presenting Signature Miniature Golf

Miniature Golf is the perfect addition to any leisure facility, targeting fun-seeking families and serious golfers alike, irrespective of abilities or age.

Signature Miniature Golf has redefined the standards of miniature golf entertainment. Our award winning designs capture the imagination of a much broader age range and dramatically increase repeat visit percentages, meaning a highly profitable attraction with swift ROI.









Introducing Championship Miniature Golf

International Golf Development and gsa golfsportagentur have joined forces in a collaboration to deliver Championship Miniature Golf to the market. Our commitment is to develop the game of golf to appeal to all ages and genders.



Turnkey Solution

We provide a full turnkey solution from concept, design, construction, synthetic turf supply and installation and operational consultancy services.

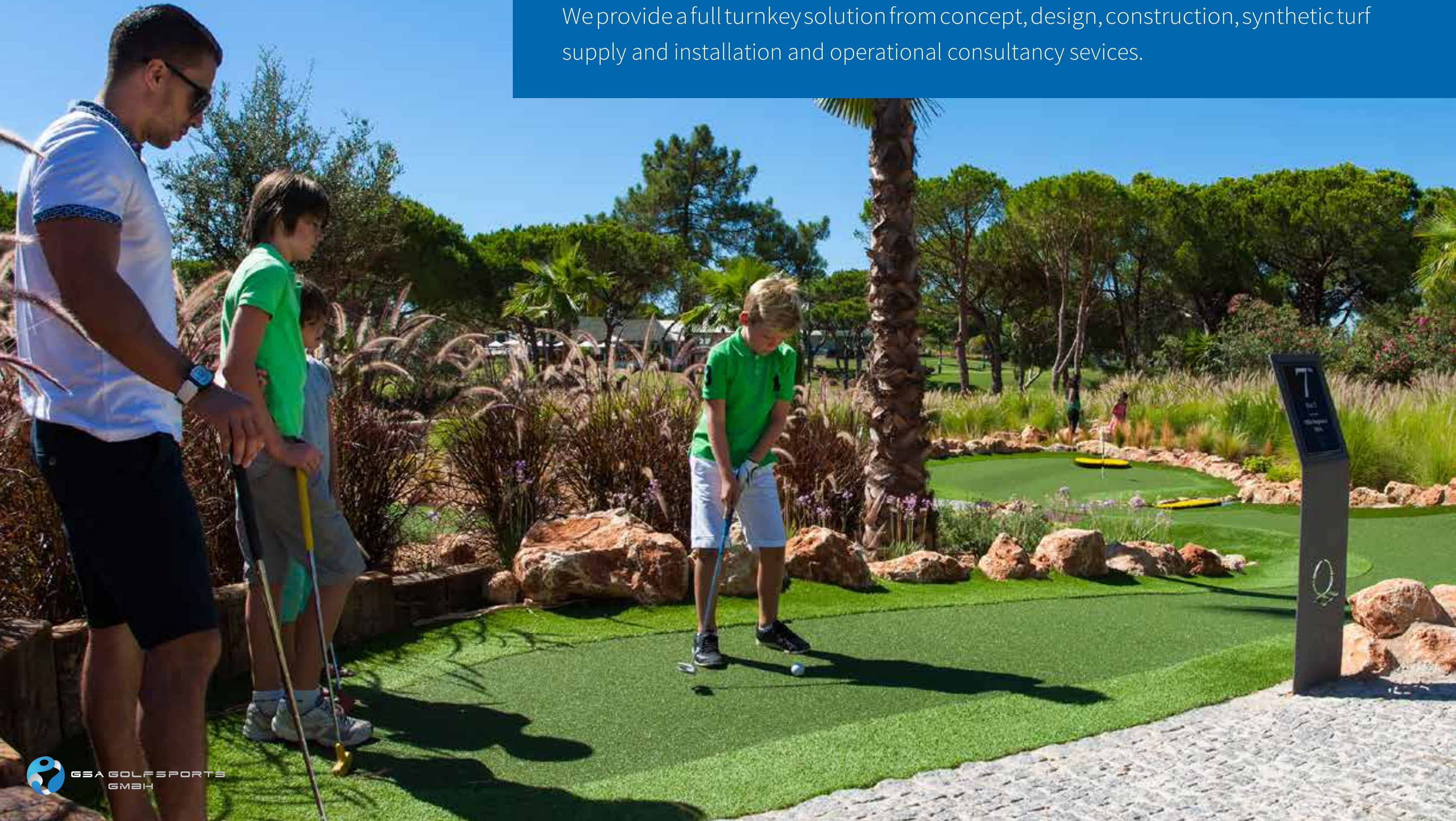



Case Study

Quinta do Lago, Algarve, Portugal

The Project

To design and build a 9-Hole Miniature Golf course inspired by some of the world's most iconic signature golf holes.

Detailed Build Steps & Timelines

Phase 1: Requirements – 2 to 4 weeks

1. **Project Site survey**
2. **Define available space**
3. **Draft design and plans**
4. **Define Scope of Work (SOW)**
5. **Finalise costs**
6. **Finalise revenue / JV model**
7. **Sign contracts**

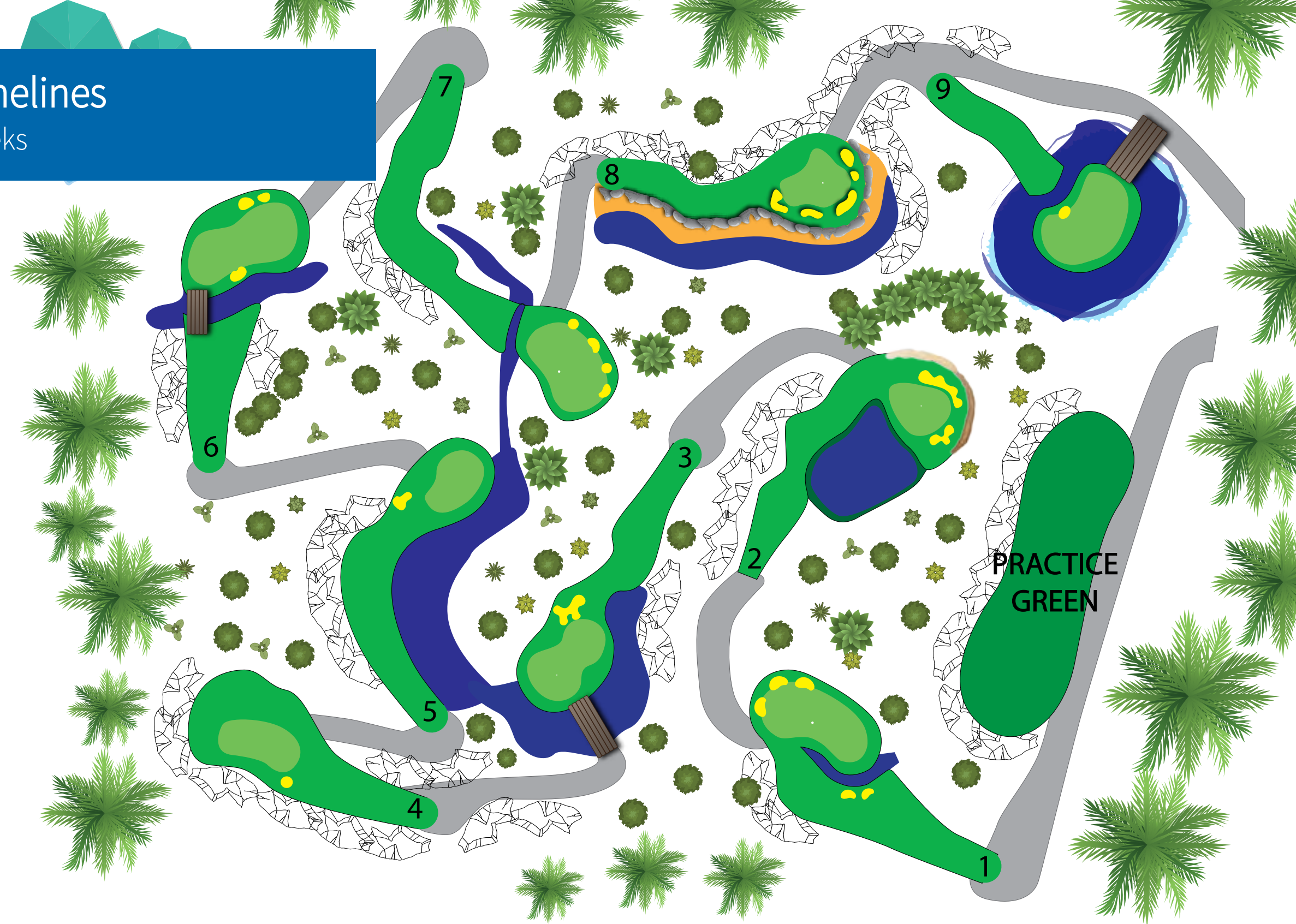

Styled on iconic holes from around the world:

- | | | |
|---------------------------------|------------------------------|------------------------------|
| 1 10th The Belfry, England | 4 8th Royal Troon, Scotland | 7 13th Augusta National, USA |
| 2 12th Abu Dhabi Golf Club, UAE | 5 13th Celtic Manor, Wales | 8 7th Pebble Beach, USA |
| 3 8th Doha Golf Club, Qatar | 6 12th Augusta National, USA | 9 17th TPC Sawgrass, USA |

Detailed Build Steps & Timelines

Phase 2: Preparation – 2 to 4 weeks

8. **IGD provide project plan and schedule**
9. **Customer ensures clear access to site**
10. **Customer ensures water & electricity available**
11. **Customer confirms appropriate planning permissions in place**
12. **Site cleared**
13. **Materials shipped from IGD**
14. **Locally sourced materials ordered (ie stone, sand, sleepers)**
15. **Machinery ordered**
16. **Security fencing erected (if required) along with lockable storage and temporary toilet facilities (if required)**
17. **Travel arrangements confirmed and booked for IGD team**







Detailed Build Steps & Timelines

Phase 3: Construction & Shaping – 3 to 4 weeks

18. **IGD team arrive on-site**
19. **Site surveyed and clearance checked**
20. **Mark out course**
21. **Mark out boundary**
22. **Shape the holes**
23. **Build walls, sleepers and base for major features along with larger landscaping works**
24. **Ensure cabling laid for any lighting – local electrician(s) required for this to meet local legislation**
25. **Lay drainage if required**
26. **Layer 1 – crushed concrete**



Detailed Build Steps & Timelines

Phase 3: Construction & Shaping – 3 to 4 weeks

- 27. **Layer 2 – Type One concrete laid**
- 28. **Layer 3 - 5mm to dust laid (or equivalent)**
- 29. **Walkways defined/laid (locally sourced)**
- 30. **Ditches for features prepared**
- 31. **Planting areas between holes established**
- 32. **Wet and compact the aggregate**
- 33. **Verify undulations and lay of land**



Detailed Build Steps & Timelines

Phase 4: Turf and Features – 3 to 4 weeks

- 34. Lay turf – greens and fringes
- 35. Install cups
- 36. Infill turf with sand – ca 0.5 tonnes per hole
- 37. Wet Pour added for water, sand and beach features
- 38. Landscaping & fencing
- 39. Addition of further features where applicable
(ie bunkers)
- 40. Construction of Checkin Hut

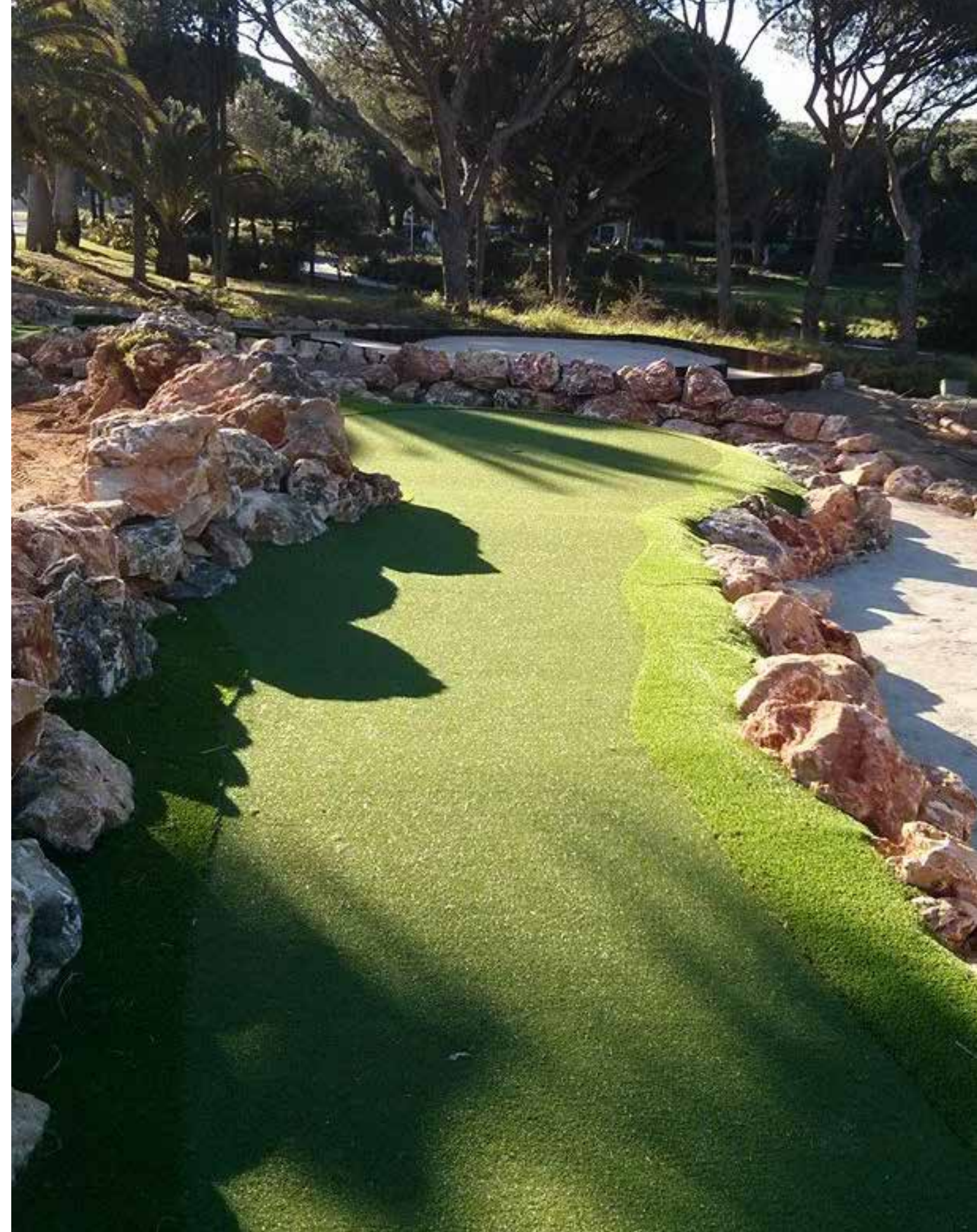





Detailed Build Steps & Timelines

Phase 5: Preparing to Open – 2 weeks

41. **Flags/pins ordered ready for opening**
42. **Signage ordered**
 - 18 tee signs
 - Pricing, rules and terms and conditions signage produced
43. **Putters ordered**
 - 6 different sizes and colours, rubber headed for safety.**IGD recommends at least 12 of each size/colour = 72 in total**
44. **Balls ordered**
 - 8 different colours x 15 of each colour = 120 balls
45. **Scorecards ordered**
46. **Ensure appropriate EPOS and reception facilities installed in hut**
47. **Open!**











6 months after
opening...





MINI GOLF



GSA GOLFSPO RTS
GMBH





7th

PAR 5

Inspired by

13th Augusta
USA



GSA GOLFSPORTS
GMBH



Revenue Statistics...

Quinta do Lago

Algarve Portugal

12,000 rounds in 4 months and
total earnings of 120,000

ew Brighton

nited ingdom

25,000 rounds played within 6 months of
opening. Total earnings of nearly 250,000

Projected ROI within 2 years

Implementaton of a demonstrable revenue model delivering a stabilized annuity income stream.

The operational template, ensures appropriate levels of Opex. and as a result consolidating profitable trading.

IGD & gsa's experience ensures efficient design and installation appropriately matching the required Capital Investment, and ensuring an ROI in keeping with the required IRR s.

Thank You!



GSA Golfsports GmbH
Schleissheimer Str. 232c
Showroom: Hornstr. 1
80797 Munich, Germany

Email: info@gsagolfports.com
Tel.: +49 89 2429 0540
Fax: +49 89 2429 0668

gsagolfports.com